

PARTS LIST

Remote Engine Starter Unit Kit P/N 08E91-T2A-100

Transmitter



Control unit

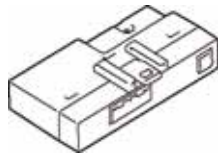

Antenna



ID label



Remote Control Engine Starter Attachment Kit P/N 08E92-T5A-100D

Engine starter harness

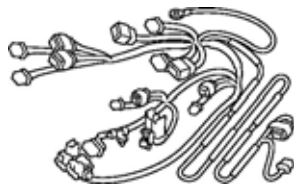

Control unit bracket



3 Relays

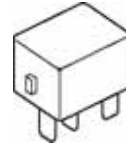

20 Wire ties



4 Long wire ties



Wire tie with clip



Ground bolt



2 Aluminum tapes



6 Urethane tapes



Caution label



Fuse label

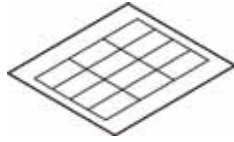

Clip

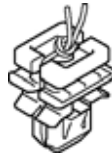

Accessory User's Information Manual



Quick Start Guide



TOOLS AND SUPPLIES REQUIRED

Phillips screwdriver

Flat-tip screwdriver

Diagonal cutters

Ratchet

10 mm Socket

10 mm Open end wrench

Isopropyl alcohol

Scissors

Shop towel

Ruler

Tape measure

i-HDS

Masking tape

The following tools are available through the Honda Tool and Equipment Program. On the iN, click on Service > Service Bay > Tool and Equipment Program, then enter the number under "Search." Or, call 888-424-6857.

- Trim Tool Set (T/N SOJATP2014)
- Plastic Trim Tool (T/N SILTRIMTL10)

Illustration of the Remote Engine Start System II Installed in the Vehicle

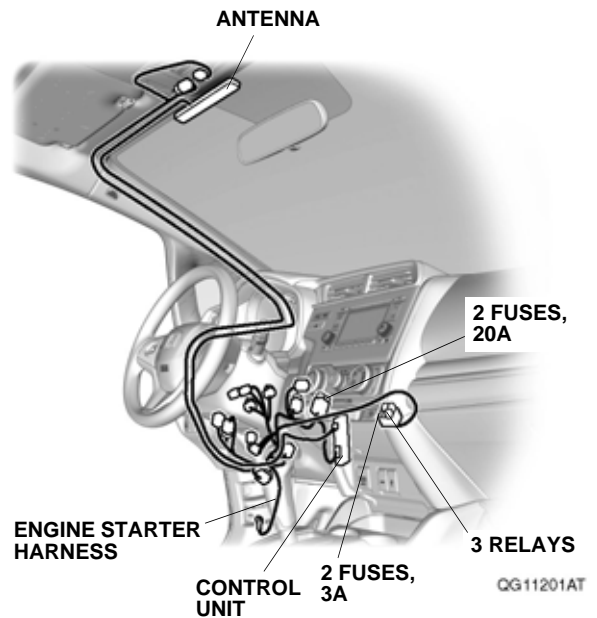

INSTALLATION

Customer Information: The information in this installation instruction is intended for use only by skilled technicians who have the proper tools, equipment, and training to correctly and safely add equipment to your vehicle. These procedures should not be attempted by “do-it-yourselfers.”

NOTE: This antenna should only be installed if the ambient air temperature 15°C (60°F) or above.

1. Disconnect the negative cable from the battery.
2. Attach the ID label.
 - Using isopropyl alcohol on a shop towel, clean the transmitter where the ID label will attach.
 - Attach the ID label to the transmitter.

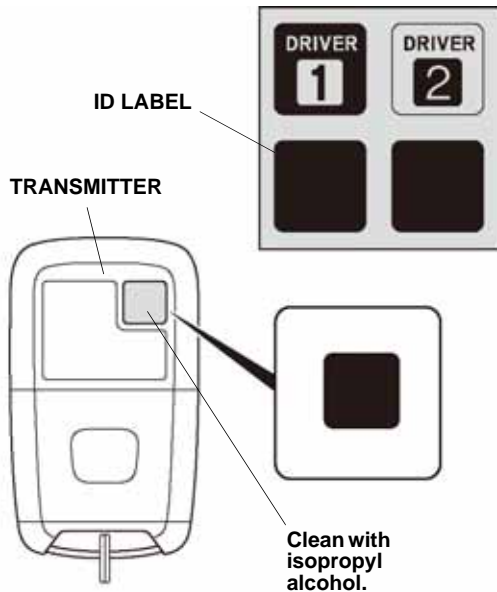

QBD0601AE

3. Remove the roof console:
 - Using a plastic trim tool, remove the left and right lenses.
 - Remove the roof console, and unplug the vehicle connectors.

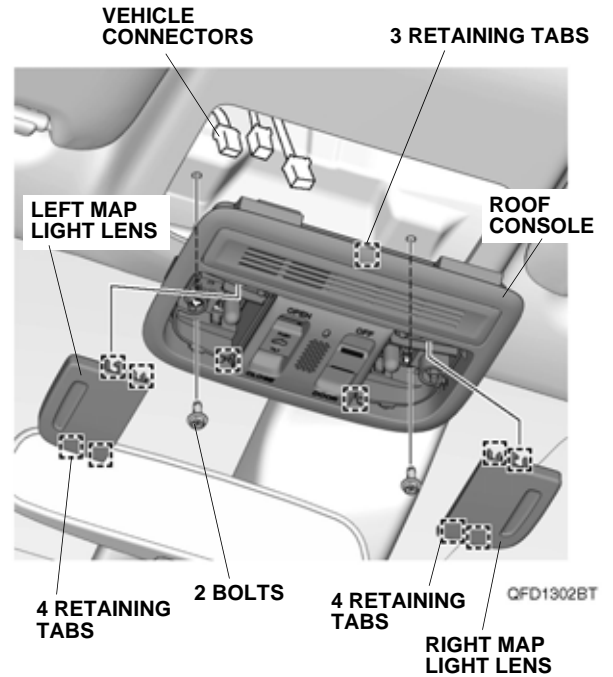

4. Release the passenger's sunvisor from the right sunvisor holder.

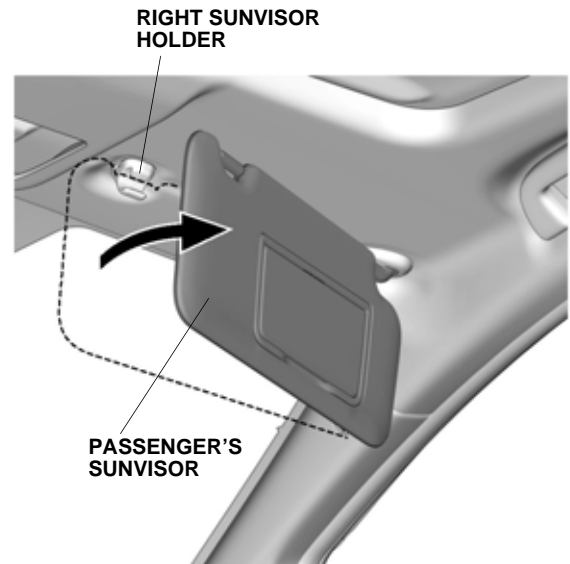

QFD1305AT

5. Remove the right sunvisor holder:
 - Wrap masking tape around the tip of a flat-tip screwdriver.
 - Release the three retaining tabs on the right sunvisor holder.

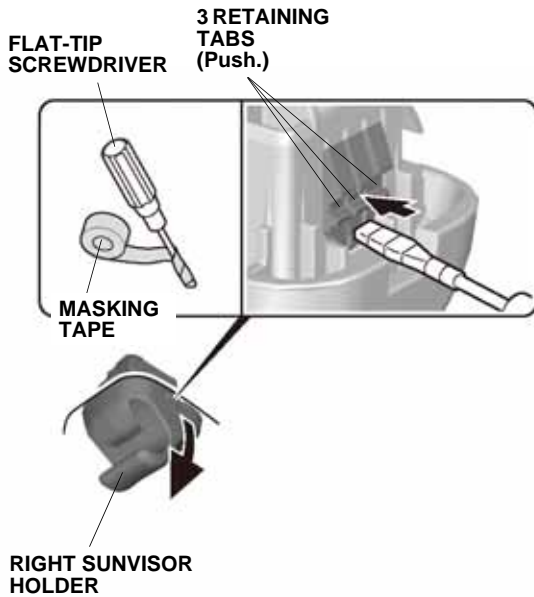

QC22003EJ

- While holding down the right sunvisor holder as shown, use a flat-tip screwdriver wrapped with masking tape to remove the right sunvisor holder.

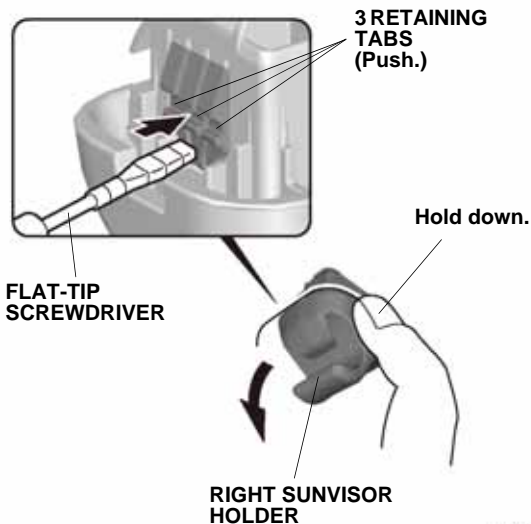

QC22004AJ

6. Remove the driver's sunvisor:
 - Pivot the driver's sunvisor downward.
 - Wrap masking tape around the tip of a flat-tip screwdriver.
 - Locate the slot in the base cover, and insert the flat-tip screwdriver into the slot. Push in and hold the retaining tab.
 - While holding the retaining tab, push up on the sunvisor and rotate it toward the door.

NOTE: If the retaining tab did not stay pushed in, return the sunvisor to its original position and repeat this step.

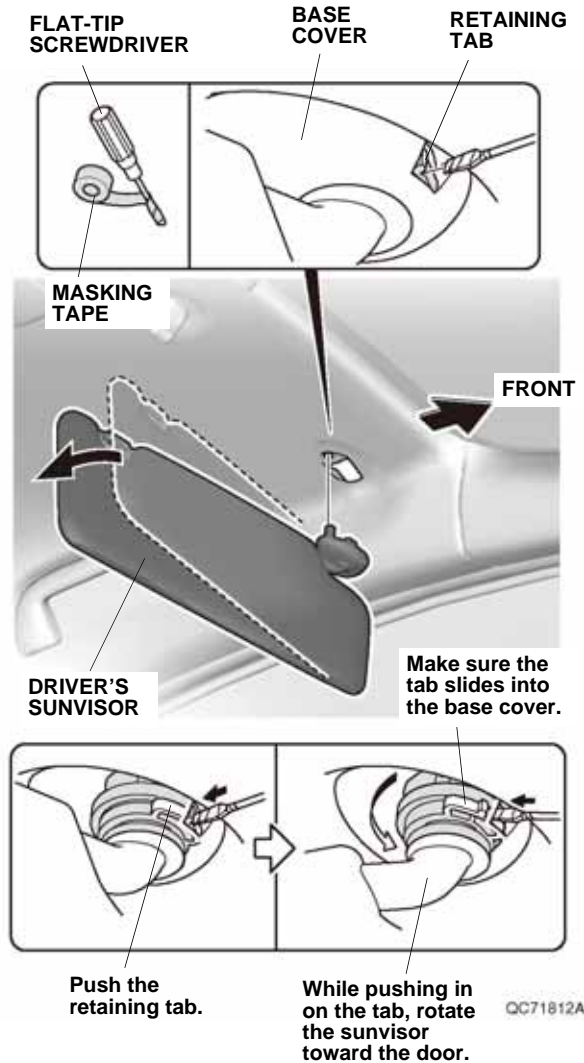

QC71812AJ

7. Remove the left sunvisor holder:
- Wrap masking tape around the tip of a flat-tip screwdriver.
 - Release the three retaining tabs on the left sunvisor holder.

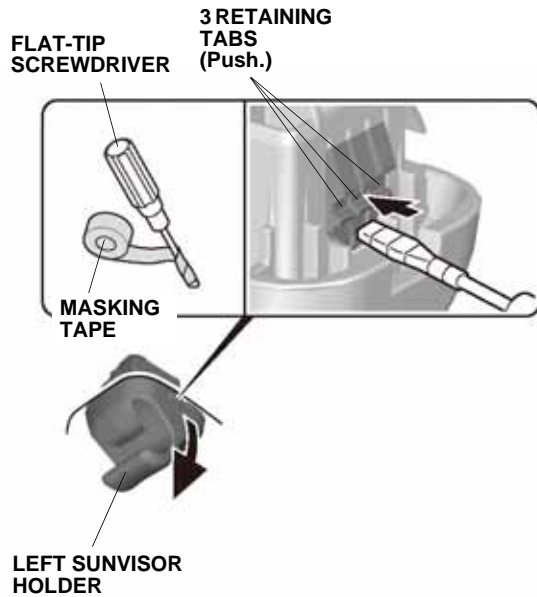

QC22003BJ

- While holding down the left sunvisor holder as shown, use a flat-tip screwdriver wrapped with masking tape to remove the left sunvisor holder.

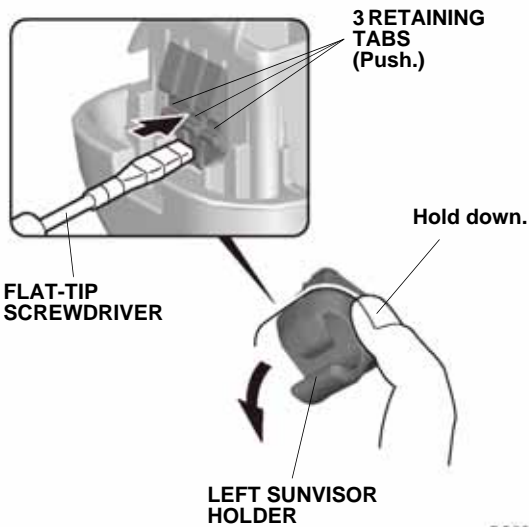

QC22004AJ

8. Remove the driver's A-pillar trim.
- Pull away the door opening seal from the driver's A-pillar trim.
 - Pull out on the driver's A-pillar trim to release the upper clip.

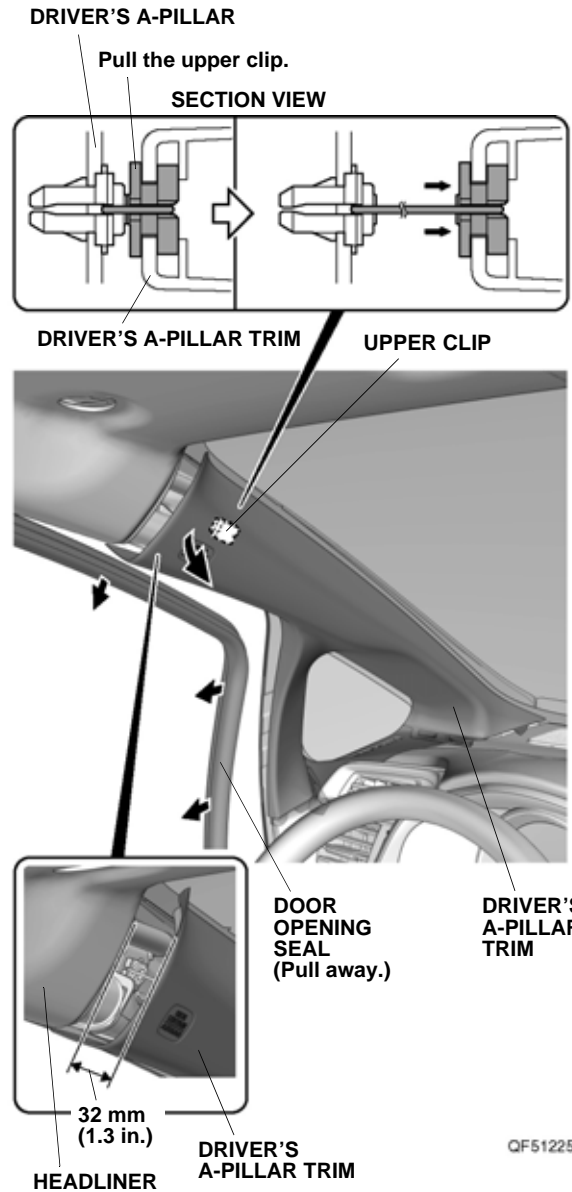

QF51225BH

- To prevent clips from falling into the body panel area, carefully insert a shop towel between the driver's A-pillar and the driver's A-pillar trim.

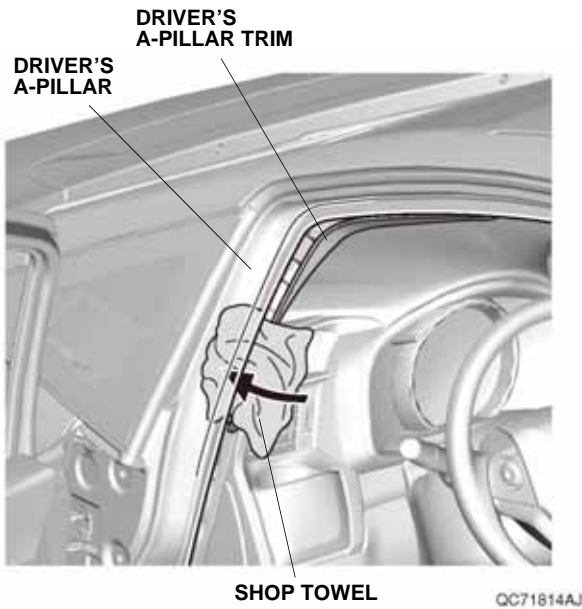

- Using scissors, cut the wires.

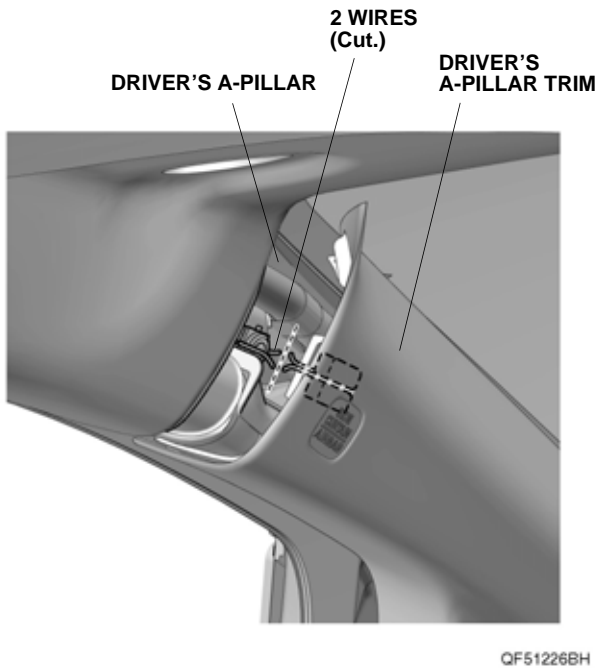

- Pull out on the driver's A-pillar trim to release two clips.
- Slide the driver's A-pillar trim upward, and remove the driver's A-pillar trim.
- Remove the shop towel and any clips.

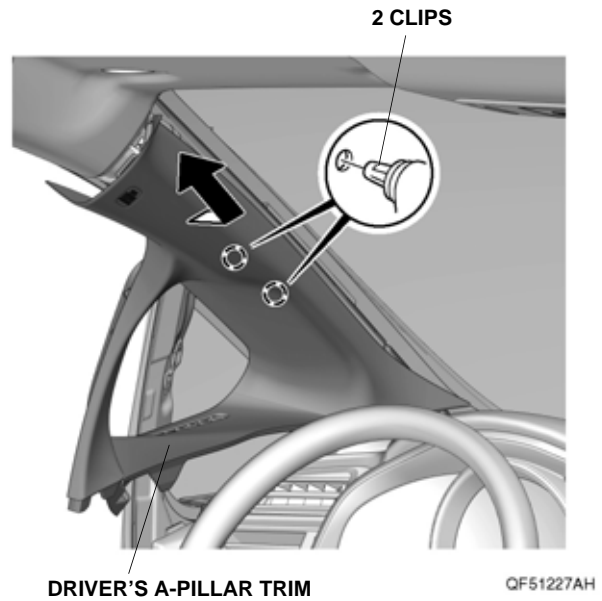

- Remove the remaining upper clip from the driver's A-pillar.

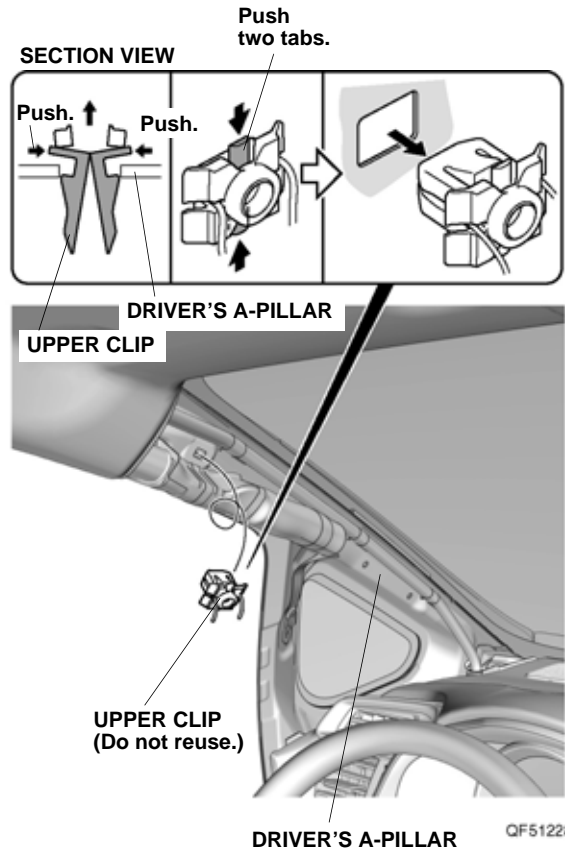

10. Remove the upper clip from the driver's A-pillar trim.

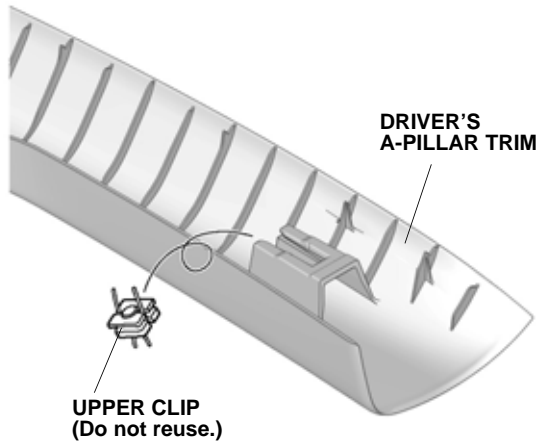

QF51229AH

11. Install the new clip (supplied) onto the driver's A-pillar trim.

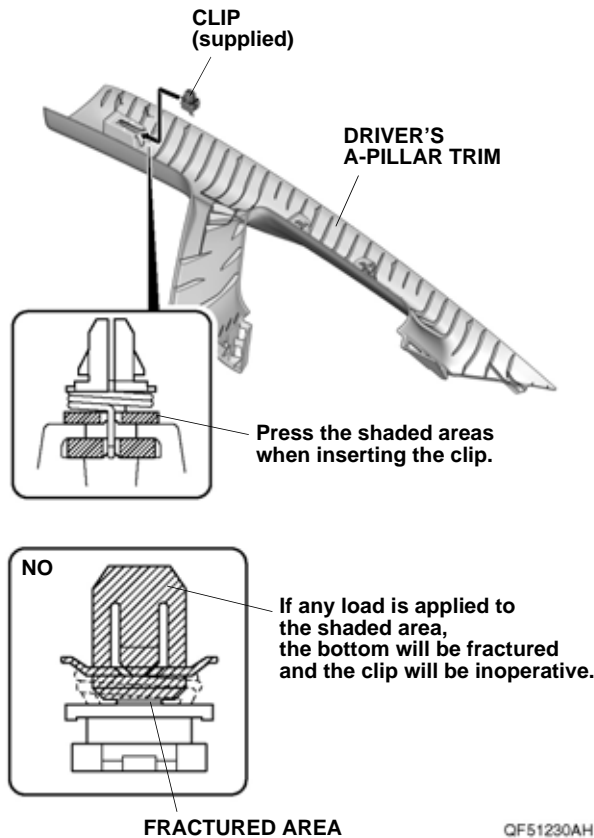

QF51230AH

12. Pull away the door opening seal, and remove the driver's dashboard side lid.

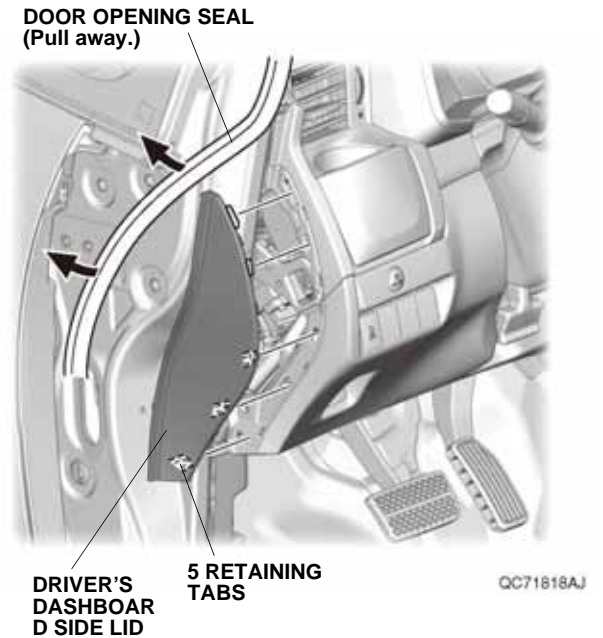

QC71818AJ

13. Remove the driver's dashboard lower cover, and unplug the vehicle connectors.

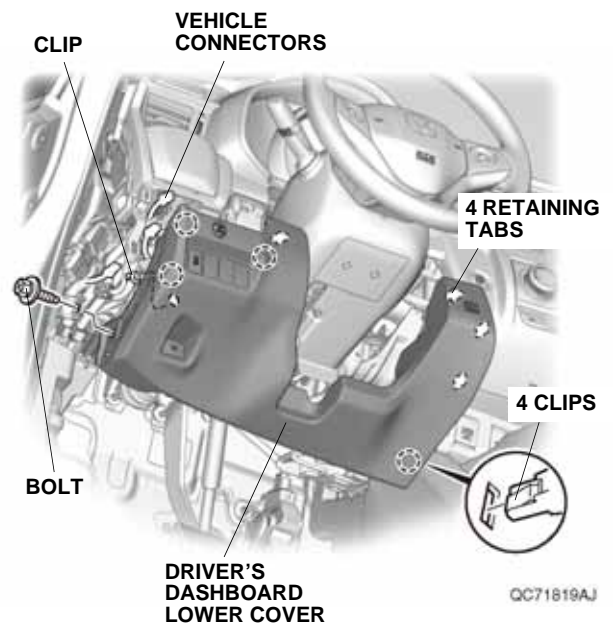

QC71819AJ

14. Pull away the door opening seal, and remove the driver's front door sill trim.

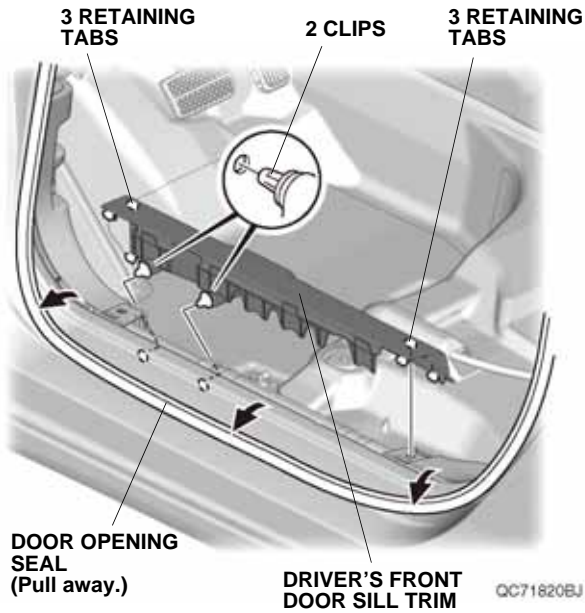

15. Pull away the door opening seal, and remove the driver's kick panel.

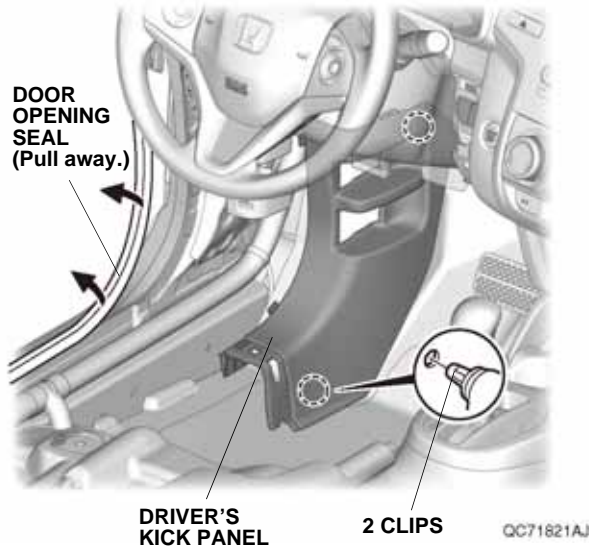

Installing the Antenna

16. Using scissors, cut one urethane tape in half. Wrap two halves of urethane tape around the antenna cable as shown.
NOTE: Do not fold the antenna cable.

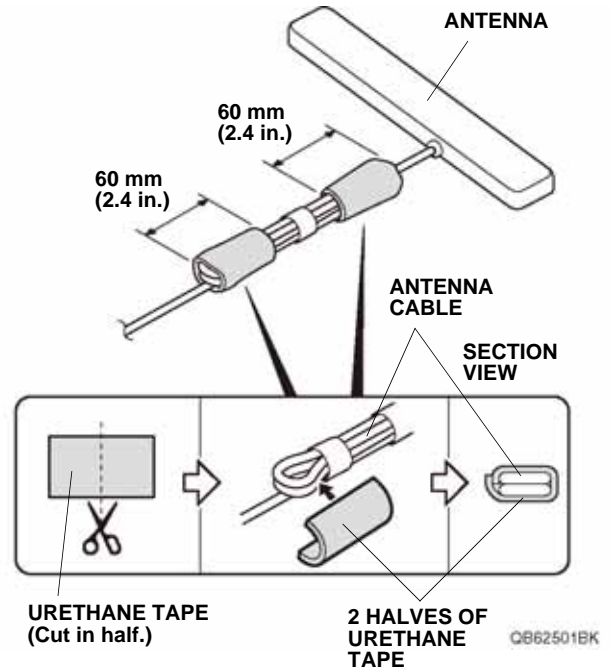

17. Using scissors, cut three urethane tapes in half. Starting near the antenna end of the cable, wrap five halves of urethane tape around the antenna cable at the measurements shown.

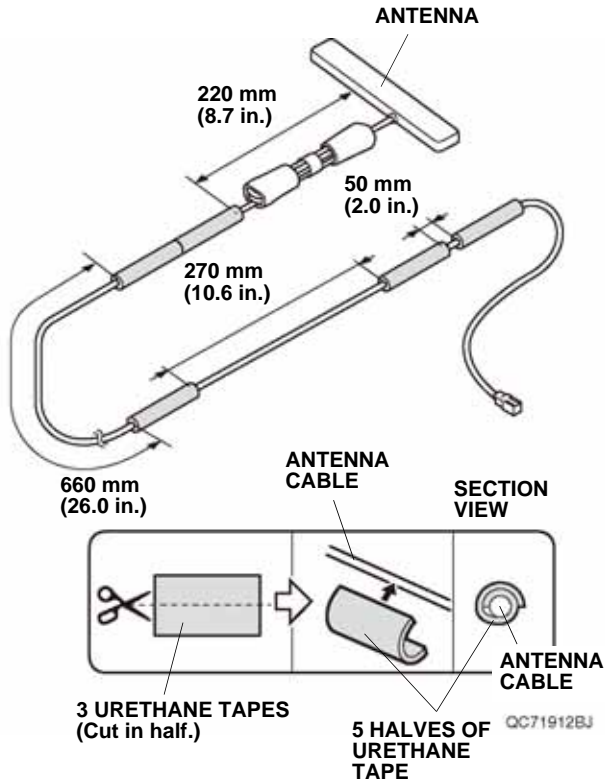

18. Attach the antenna.
 - Attach masking tape to the windshield as shown.

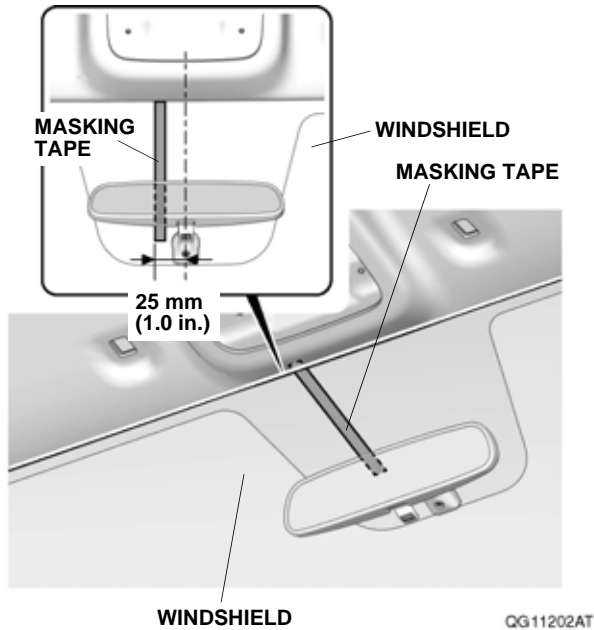

- Fold the adhesive backing of the antenna as shown.

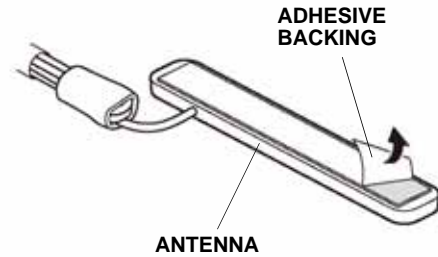

- Using isopropyl alcohol on a shop towel, clean the windshield where the antenna will attach.
- Attach the antenna with masking tape. Adjust the position of the antenna so there is equal spacing on both sides.

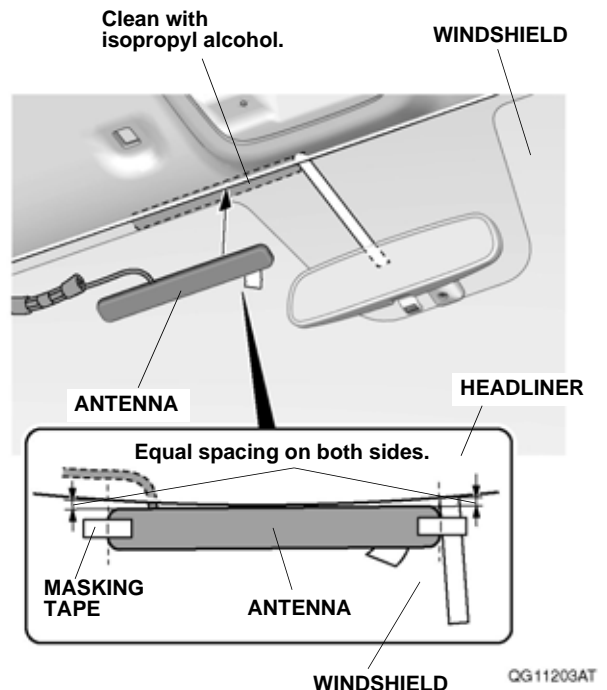

- Carefully remove the adhesive backing from the antenna, and attach the antenna to the windshield. Press and hold the antenna firmly in place for 30 seconds.
- Remove the masking tape.

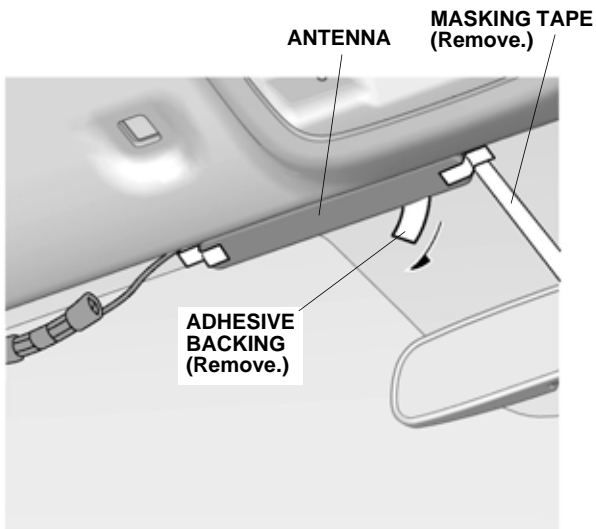

QG11204AT

- Route the antenna cable as shown.

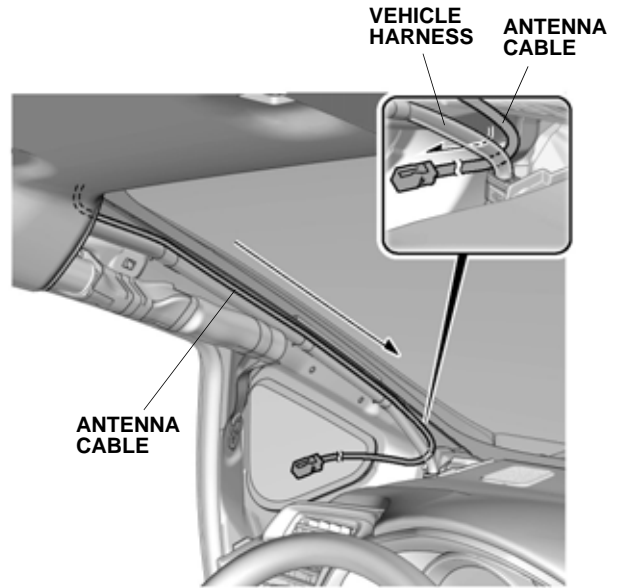

QG11206AT

- Pull away the door opening seal. Route the antenna cable, and tuck the antenna cable between the vehicle panel and the dashboard.

- Gently pull down the headliner, and tuck the antenna cable under the headliner. Be careful not to crease the headliner.

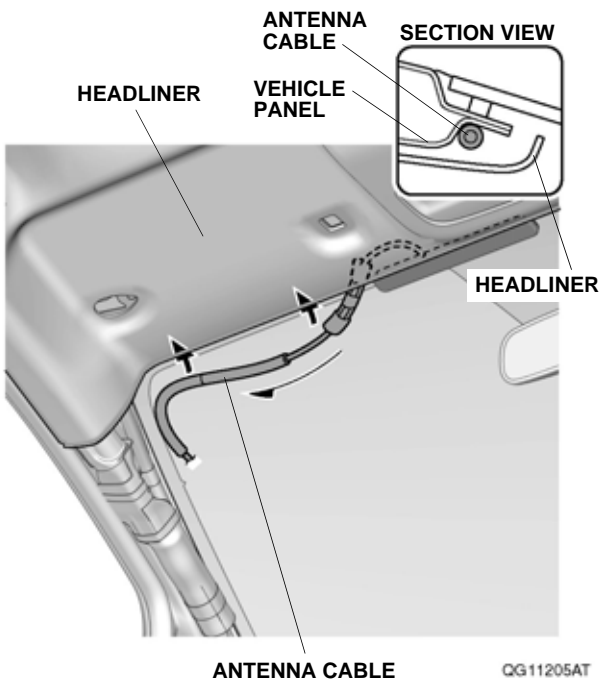

QG11205AT

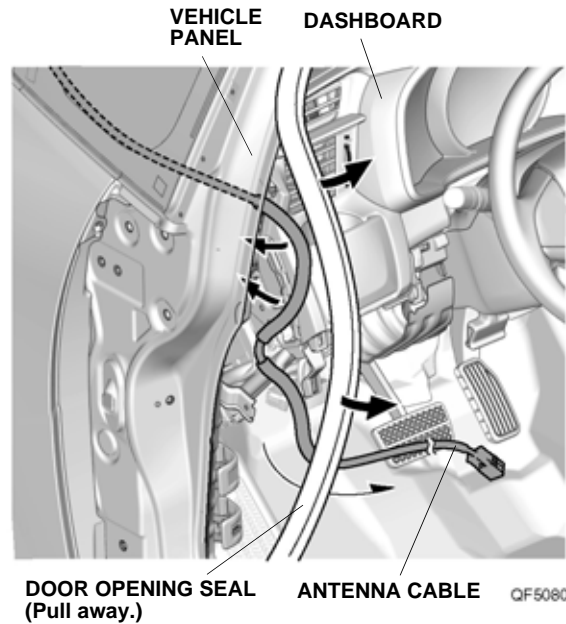

QF50803AT

Routing the Engine Starter Harness

22. Using isopropyl alcohol on a shop towel, clean the engine starter harness fuse block where the fuse labels will attach.

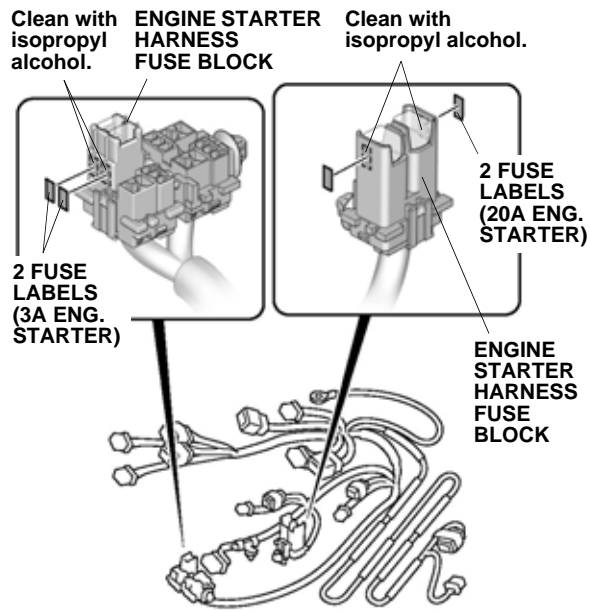

QG11207AT

23. Apply four fuse labels to the engine starter harness fuse block.
 24. Install the three relays to the engine starter harness relay block.

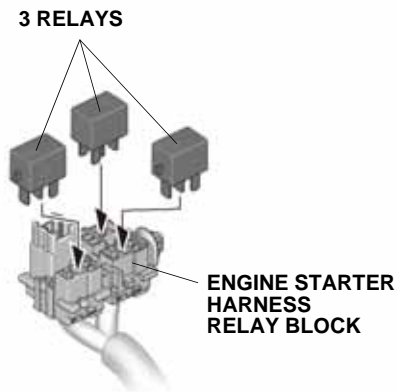

QC71307AJ

25. Using scissors, cut one urethane tape as shown. Wrap the cut urethane tape around the engine starter harness 5-pin connector.

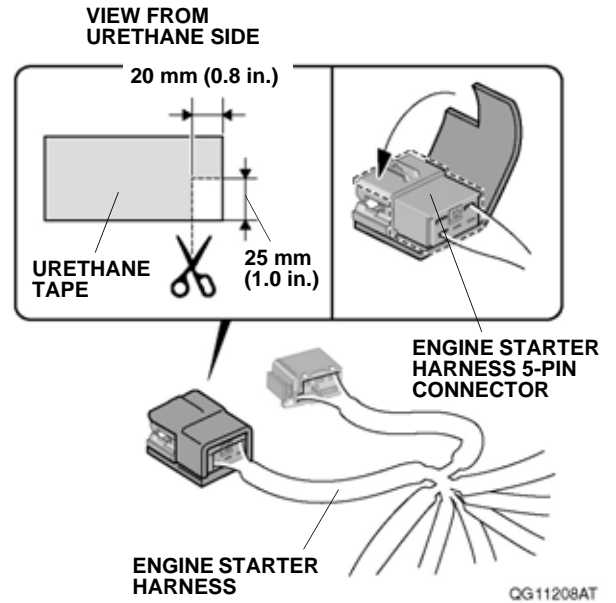

26. Tuck the engine starter harness between the vehicle panel and the dashboard.

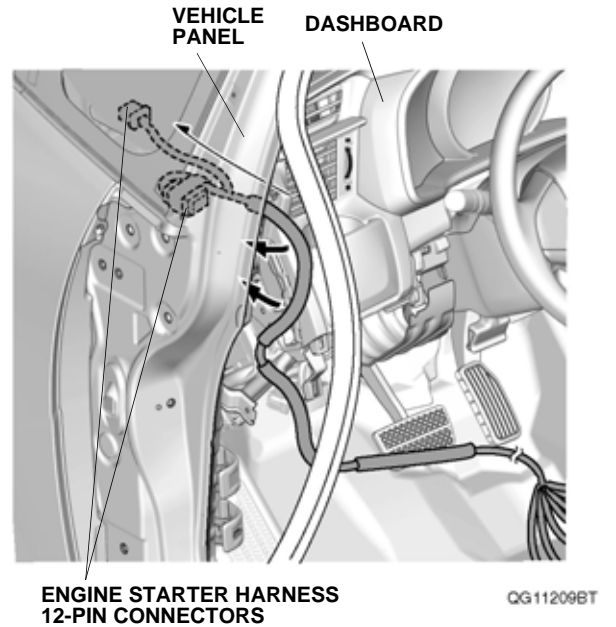

27. Route the engine starter harness as shown.

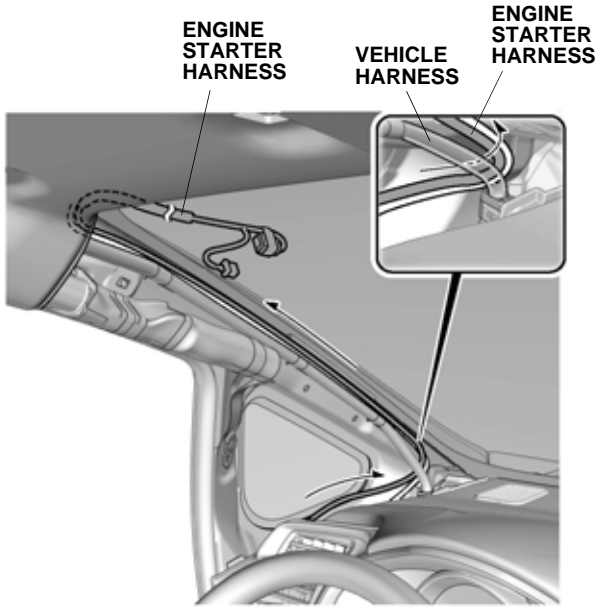

QG11210AT

28. Gently pull down the headliner, and tuck the engine starter harness behind the headliner.
NOTE: Be careful not to crease the headliner.

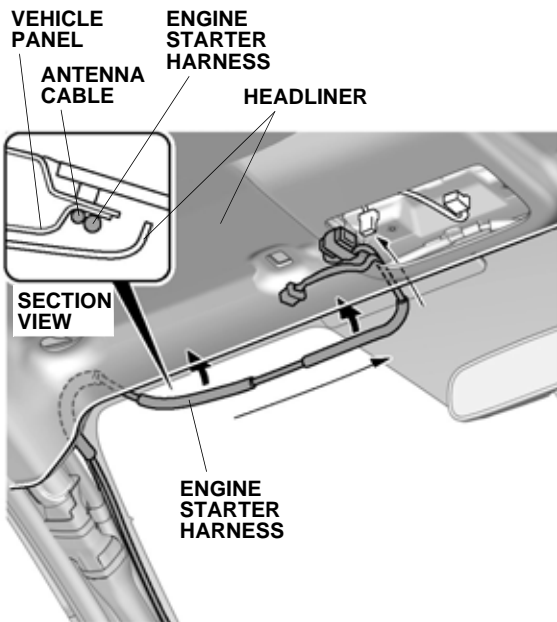

QG11211BT

29. Plug the vehicle 12-pin connector into the engine starter harness 12-pin connector.

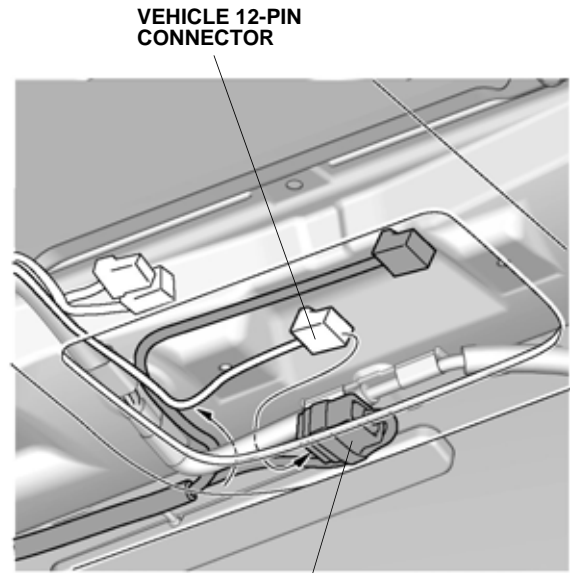

ENGINE STARTER HARNESS 12-PIN CONNECTOR

QG11212BT

30. Secure the 12-pin connectors and the engine starter harness to the vehicle harness with three wire ties.

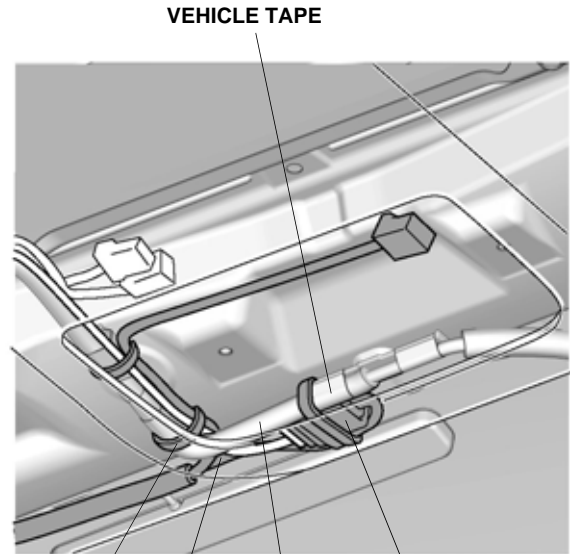

3 WIRE TIES

VEHICLE HARNESS

ENGINE STARTER HARNESS

12-PIN CONNECTORS (Line up with the vehicle tape.)

QG11213CT

- Line up the green tape on the engine starter harness with the vehicle clip, and secure the engine starter harness and the antenna cable to the vehicle harness with one wire tie.

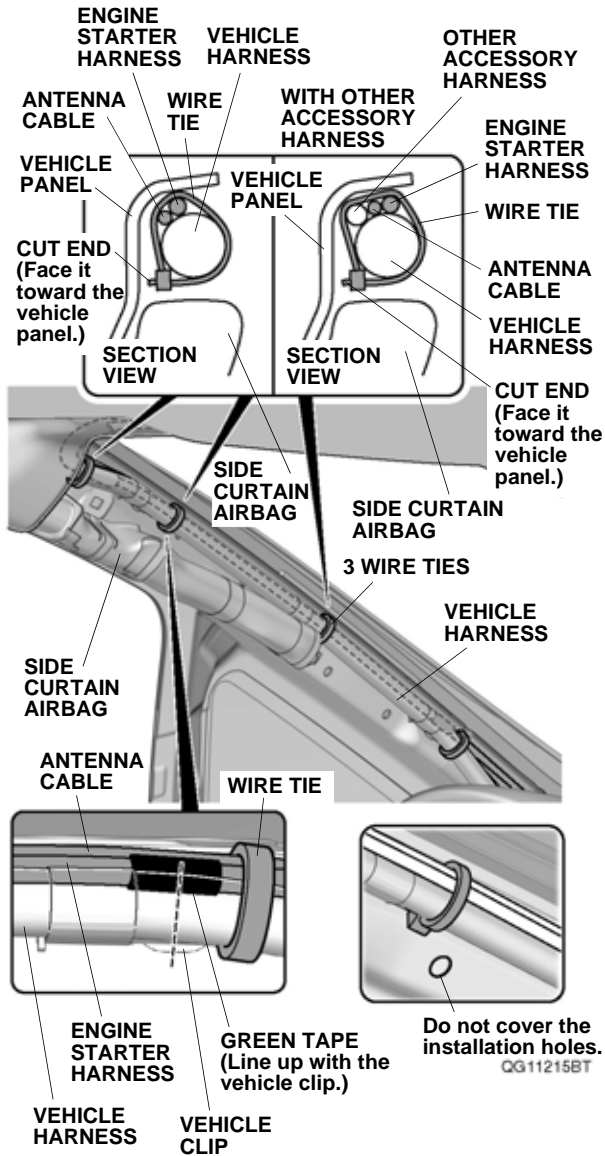

- Secure the engine starter harness and the antenna cable to the vehicle harness with three wire ties.

- Using isopropyl alcohol on a shop towel, thoroughly clean the vehicle panel where the aluminum tape will attach.

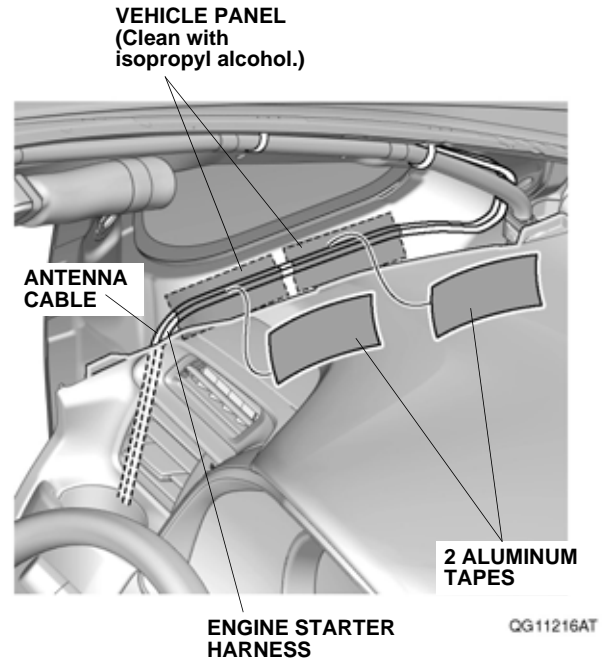

- Secure the engine starter harness and the antenna cable to the vehicle panel with the two pieces of aluminum tape.

35. Secure the engine starter harness and the antenna cable to the vehicle panel with one wire tie. If the other accessory harness is already secured to the vehicle panel, secure the engine starter harness and the antenna cable to the other accessory harness with one wire tie.

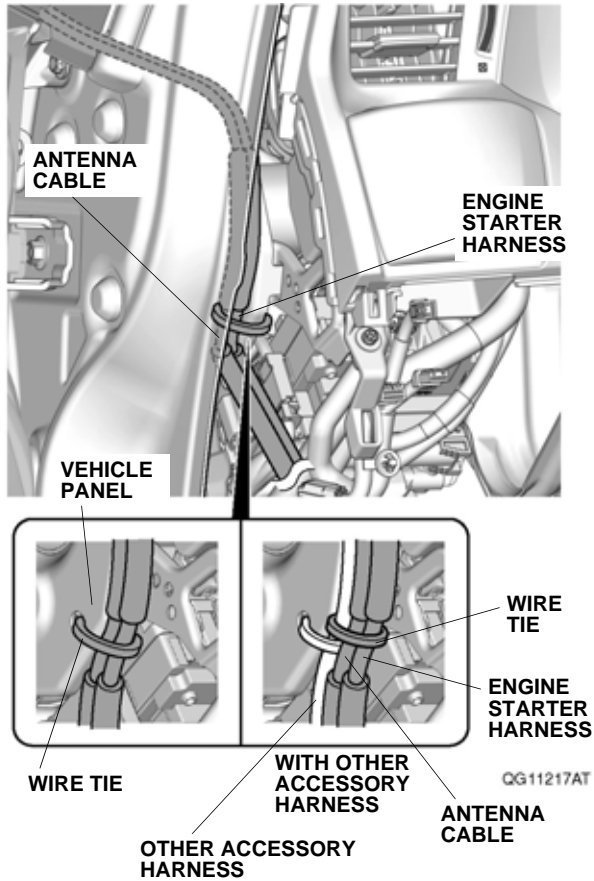

36. Release the vehicle 14-pin and 25-pin connectors from the vehicle panel, and unplug the vehicle 14-pin and 25-pin connectors.

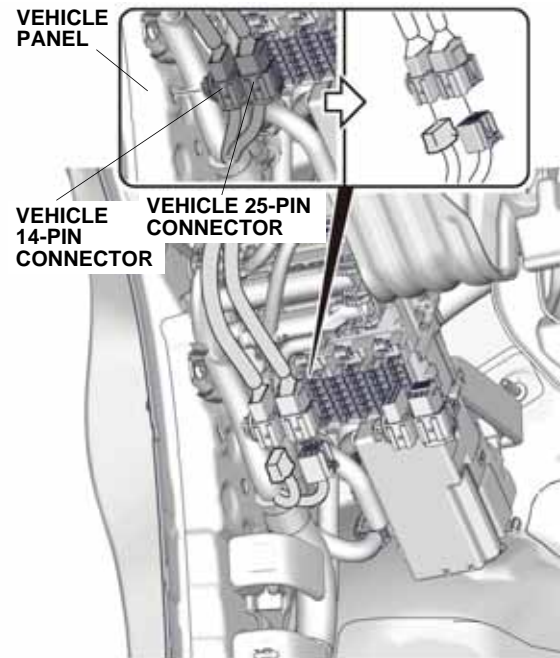

37. Release the SRS connector from the fuse box.

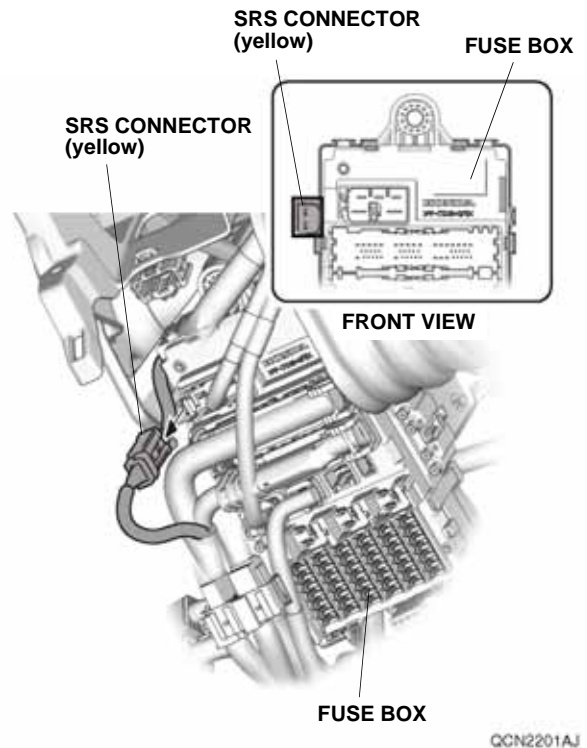

38. Unplug the vehicle 5-pin connector from the fuse box.

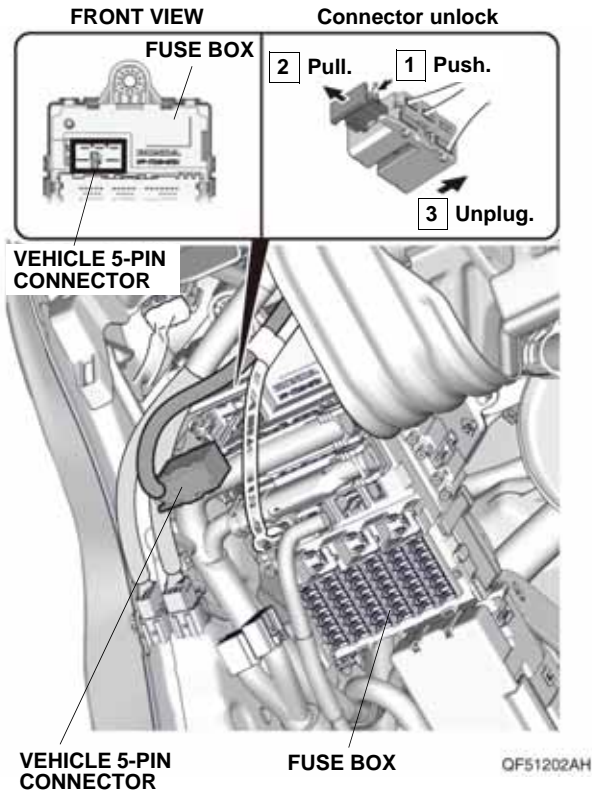

39. Unplug the vehicle 2-pin, 18-pin, 40-pin, and 52-pin connectors from the fuse box.

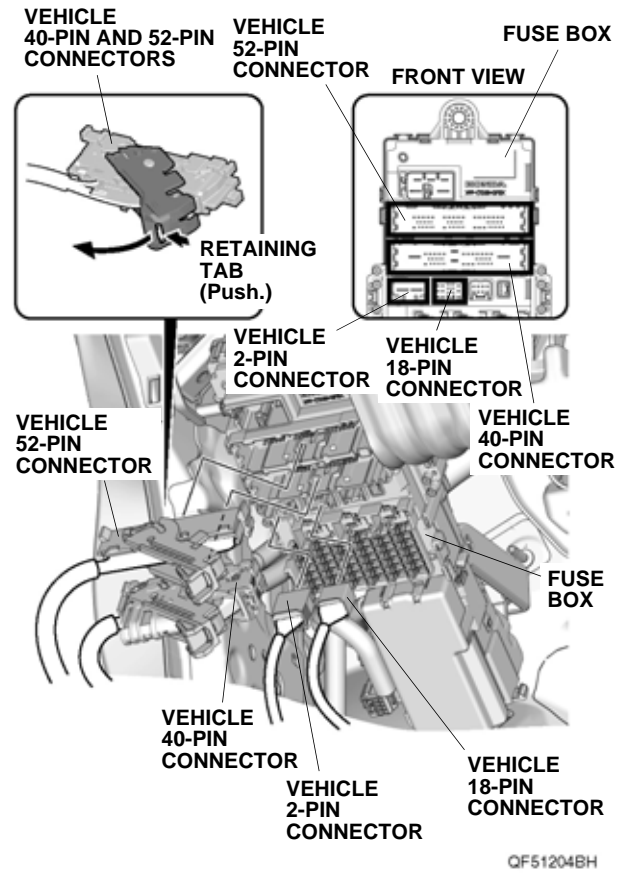

40. Release the fuse box.
- Wrap masking tape around the tip of a flat-tip screwdriver.

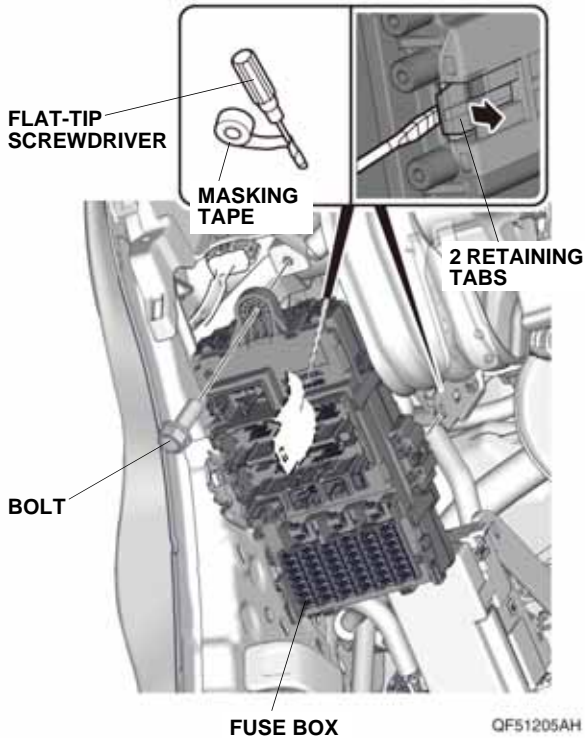

41. Unplug the vehicle 20-pin and 24-pin connectors from the fuse box, and plug them into the engine starter harness 20-pin and 24-pin connectors. Plug the engine starter harness 20-pin and 24-pin connectors into the fuse box.

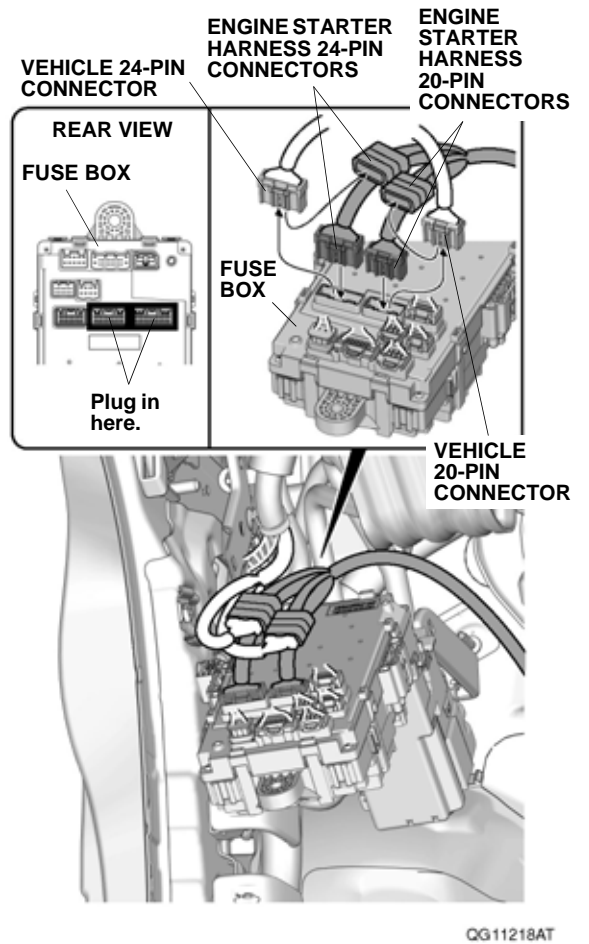

42. Route the engine starter harness down next to the fuse box, and secure the engine starter harness to the vehicle harness with one wire tie.

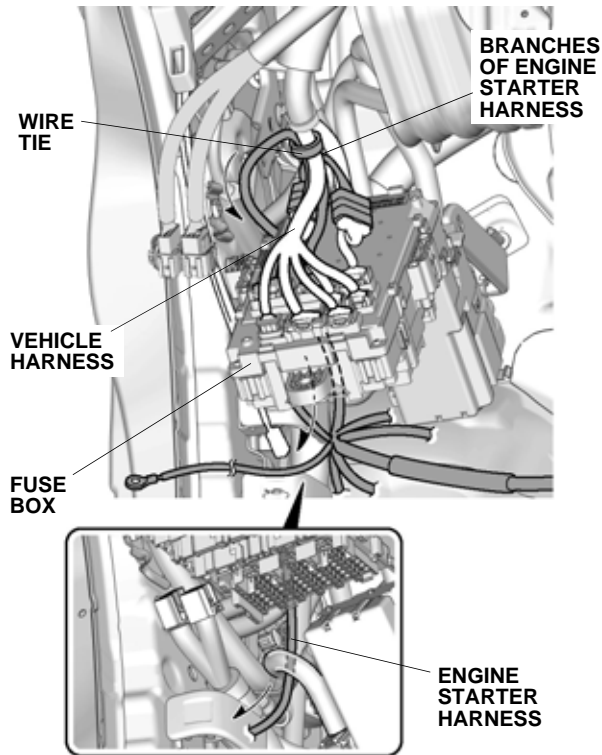

QG11219BT

43. Install the fuse box released in steps 39 and 40.
44. Install the vehicle connectors released in step 36.

45. Plug the vehicle 5-pin connector unplugged in step 38 into the engine starter harness 5-pin connector. Plug the engine starter harness 5-pin connector into the fuse box.

NOTICE: Make sure the engine starter harness 5-pin connector is securely connected to the fuse box 5-pin connector. A loose connection can cause the engine to stall during driving.

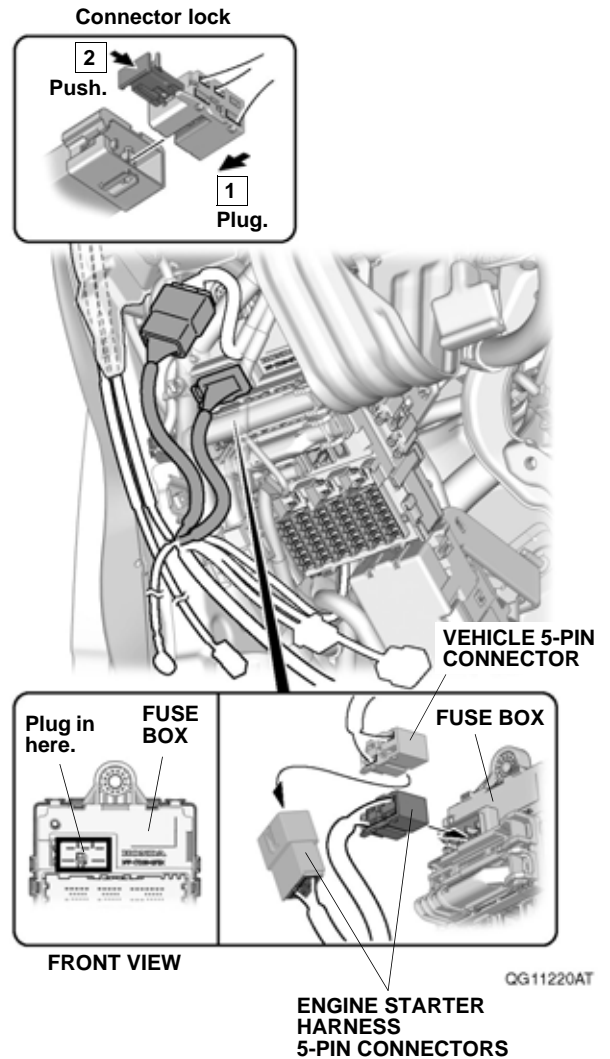

46. Install the SRS connector (yellow) released in step 37.

47. Secure the 5-pin connectors, the antenna cable, and the engine starter harness to the vehicle harness with two long wire ties.

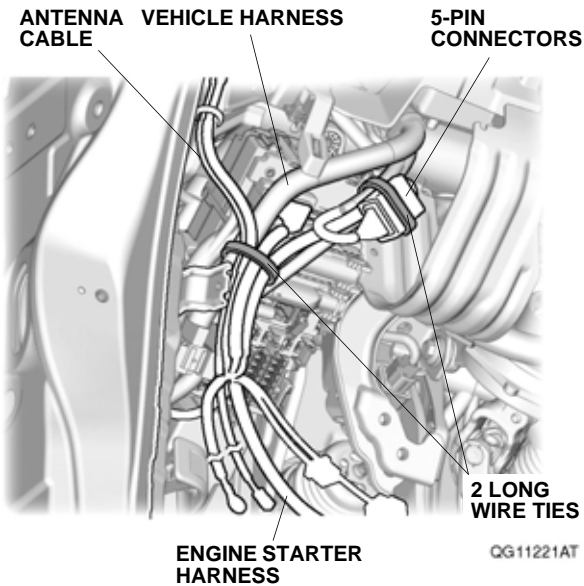

49. Secure the engine starter harness to the vehicle harness with two wire ties.

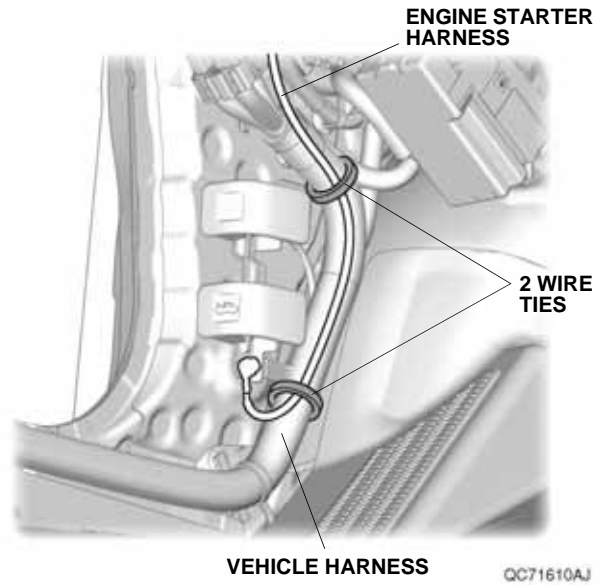

48. Route the engine starter harness along the vehicle harness. Remove the bolt, and install the engine starter harness ground terminal with one ground bolt.

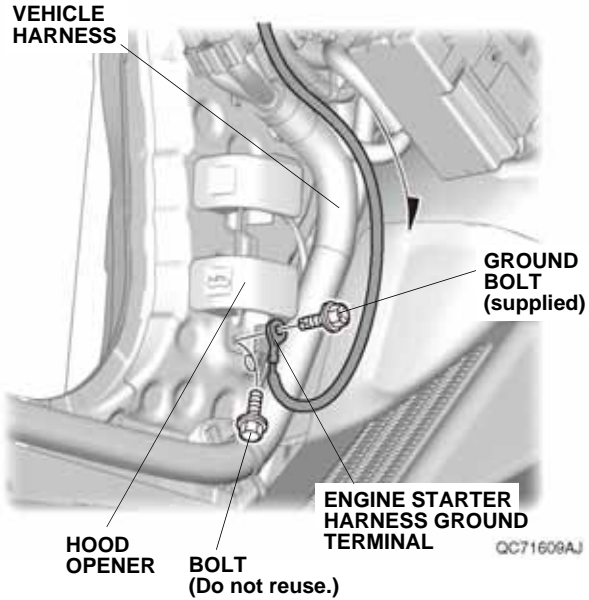

50. Release the sub fuse box from the sub fuse box bracket.

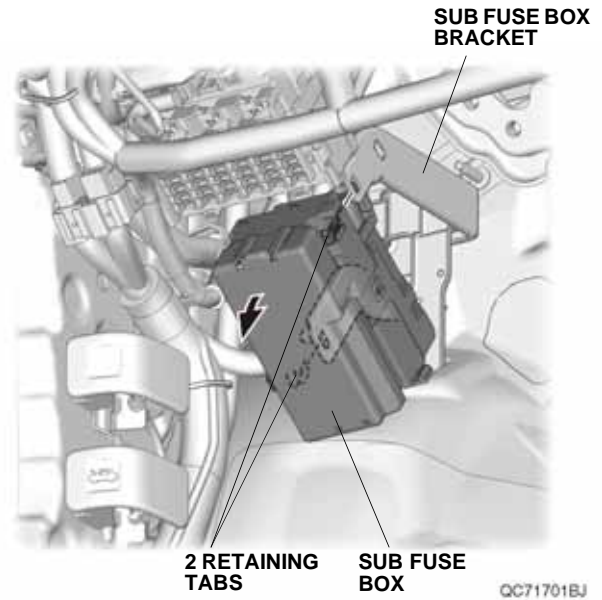

51. Remove the sub fuse box bracket.

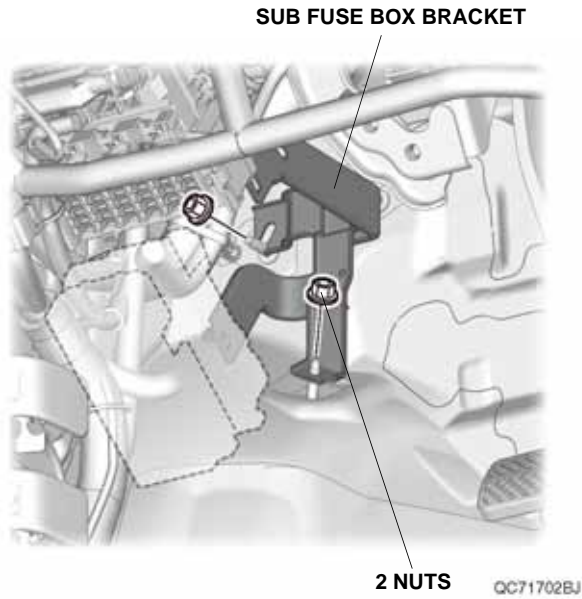

52. Unplug the vehicle 2-pin connector from the sub relay box, and plug it into the engine starter harness 2-pin connector. Plug the engine starter harness 2-pin connector into the sub relay box.

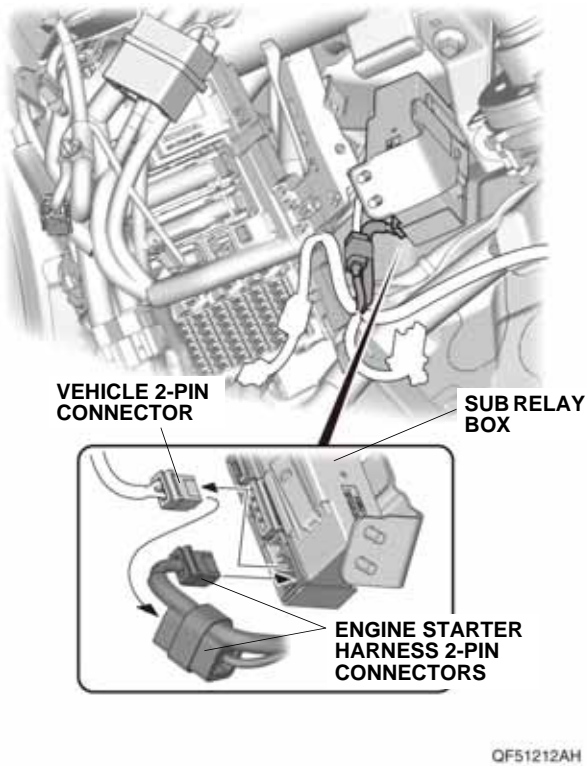

53. Secure the 2-pin connectors to the vehicle harness with one wire tie.

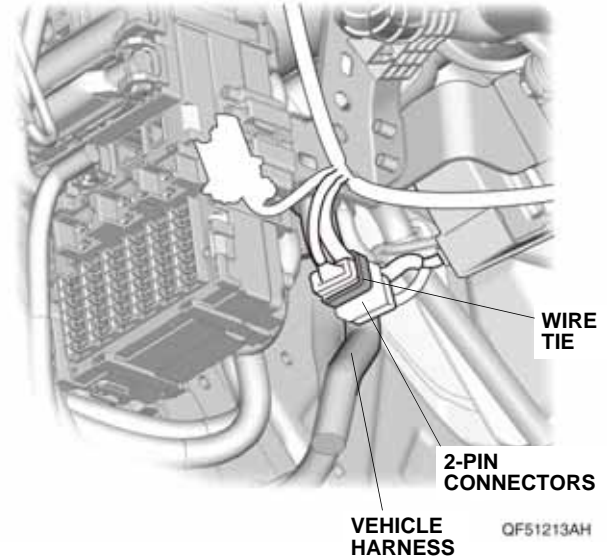

54. Plug the antenna cable connector and the engine starter harness 28-pin connector into the control unit.

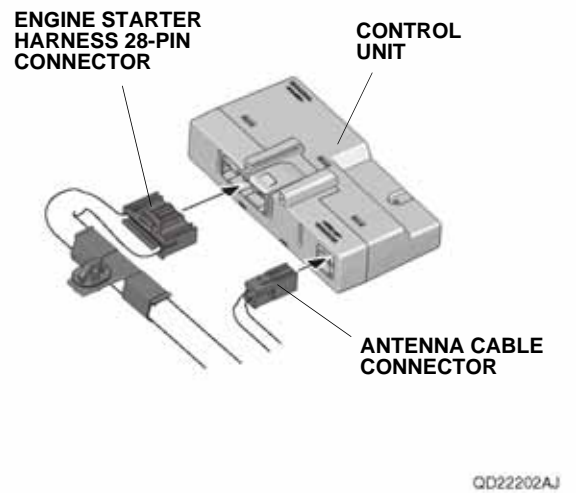

55. Using isopropyl alcohol on a shop towel, clean the control unit bracket where the urethane tape will attach.

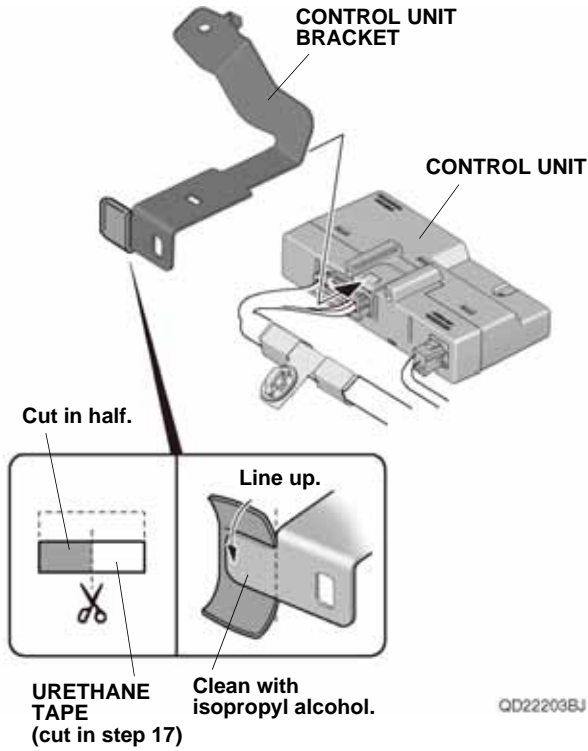

56. Using scissors, cut the remaining urethane tape in step 17 in half. Wrap the cut urethane tape around the control unit bracket as shown.
57. Install the control unit bracket to the control unit.
58. Attach the engine starter harness clip to the control unit bracket.

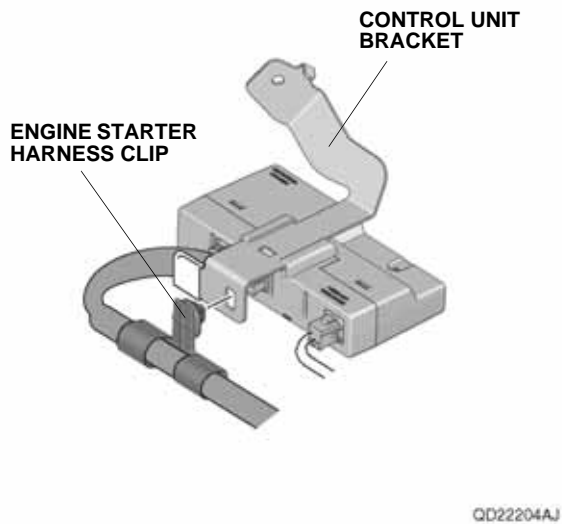

59. Secure the sub fuse box bracket (removed in step 51) and the control unit bracket in the order shown.

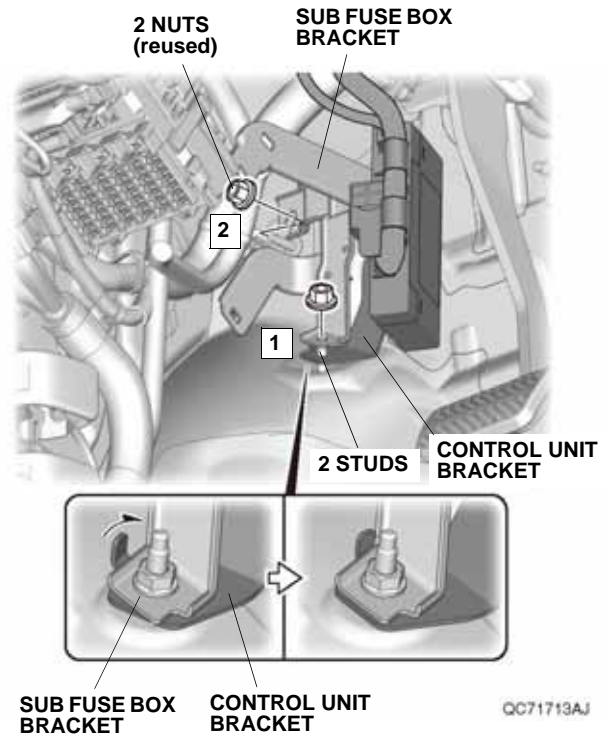

60. Install the sub fuse box released in step 50.
61. Secure the engine starter harness fuse block to the hole in the sub fuse box bracket.

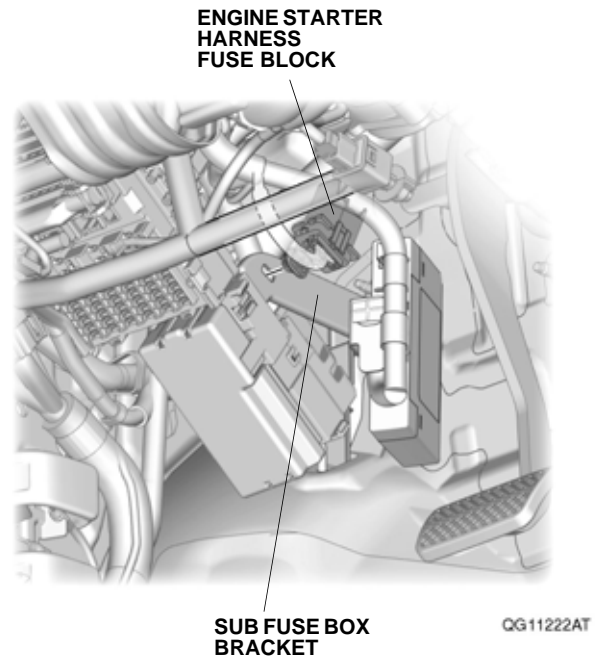

62. Plug the engine starter harness 4-pin connector into the fuse box.

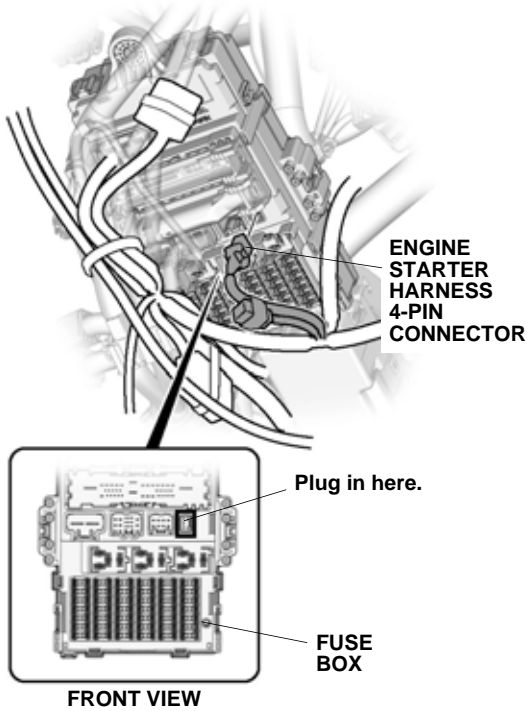

QG11223AT

63. Unplug the vehicle 25-pin connector, and plug it into the engine starter harness 25-pin connector. Plug the engine starter harness 25-pin connector into the vehicle 25-pin connector.

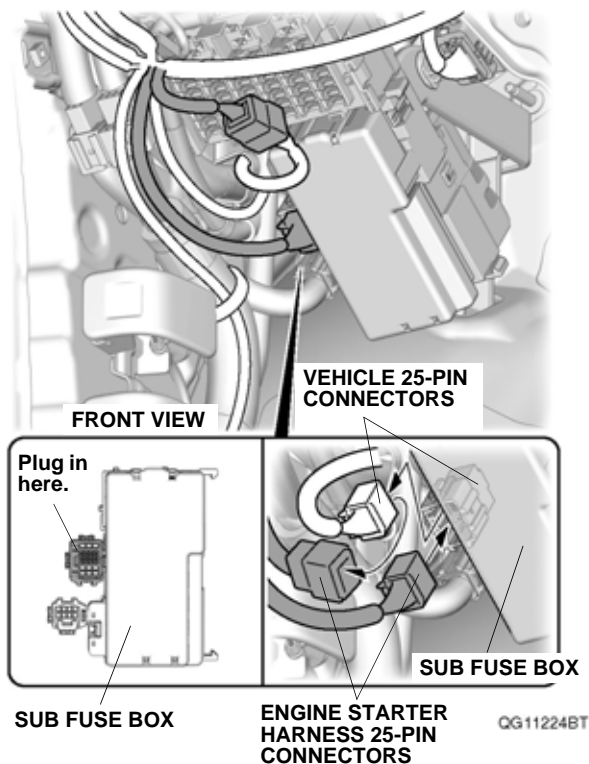

QG11224BT

64. Secure the 25-pin connectors and the engine starter harness to the vehicle harness with two wire ties and one long wire tie.

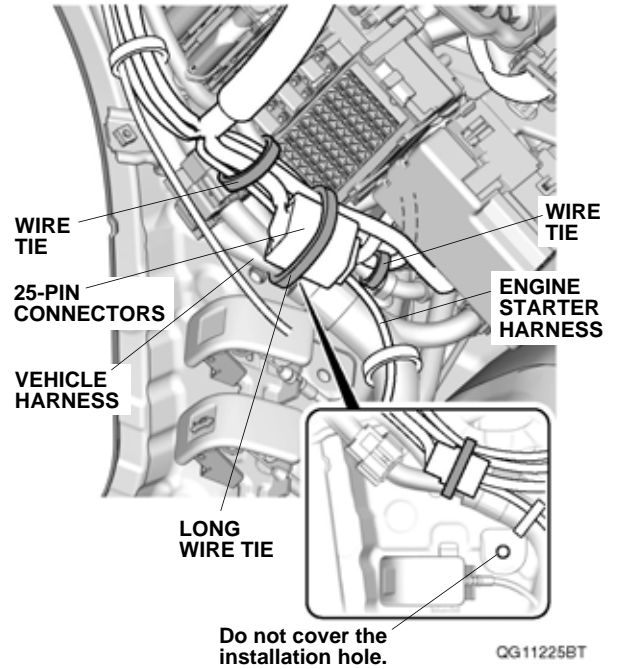

65. Route the engine starter harness behind the steering shaft as shown. Secure the engine starter harness relay block to the hole in the vehicle panel.

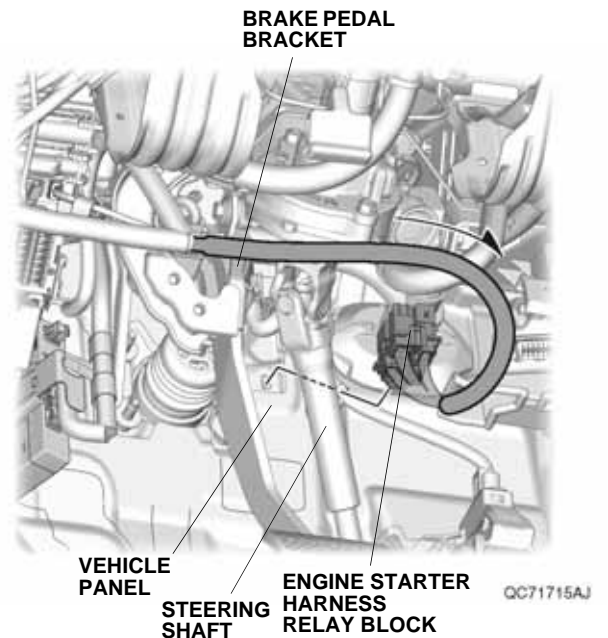

66. Line up the white tape on the engine starter harness with the vehicle clip, and secure the engine starter harness to the vehicle harness with four wire ties.

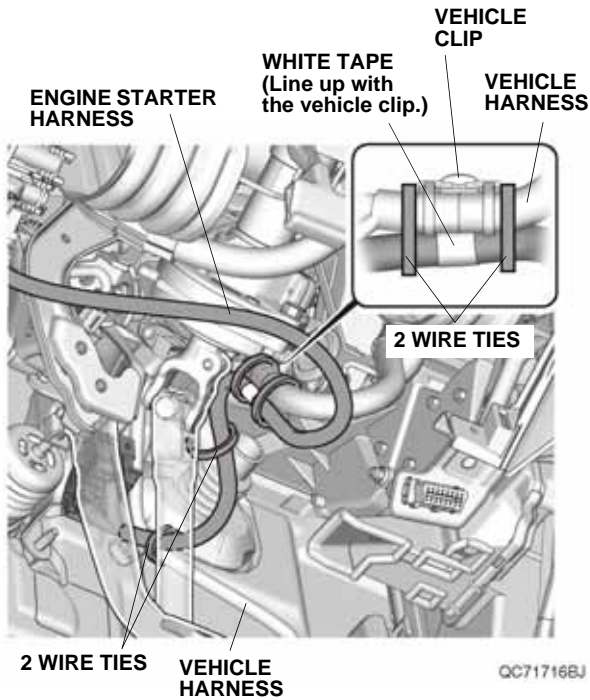

67. Secure the engine starter harness to the steering hanger beam with one wire tie.

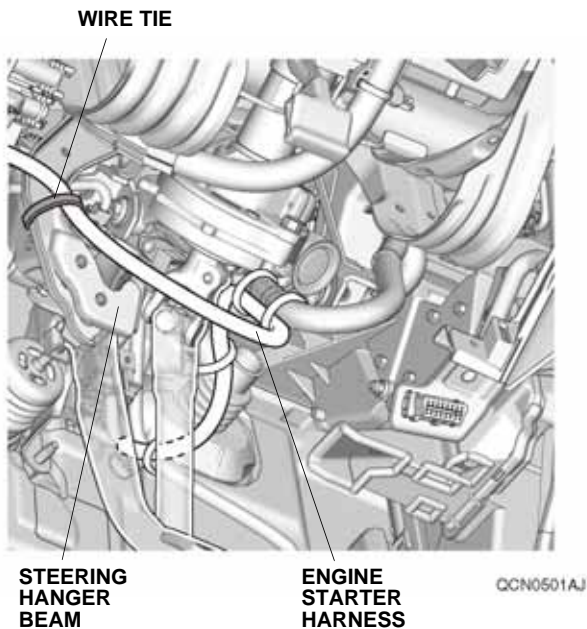

68. Secure the engine starter harness and the antenna cable to the knee bolster with one long wire tie.

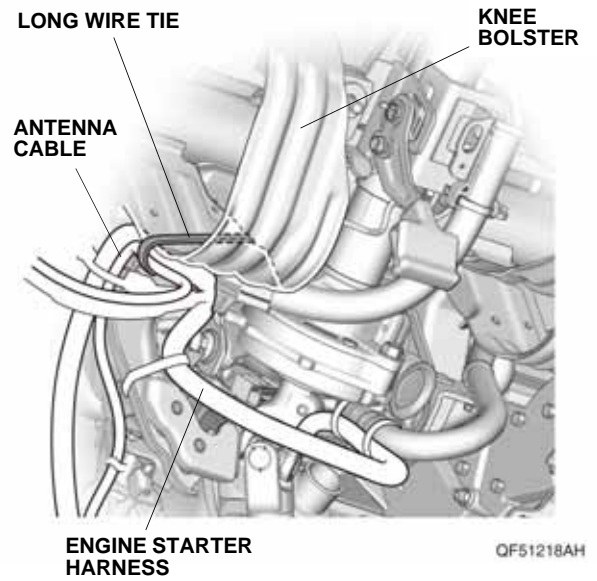

69. Secure one wire tie with clip to the antenna cable and the engine starter harness at the white tape, and secure the wire tie with clip to the hole in the steering hanger beam.

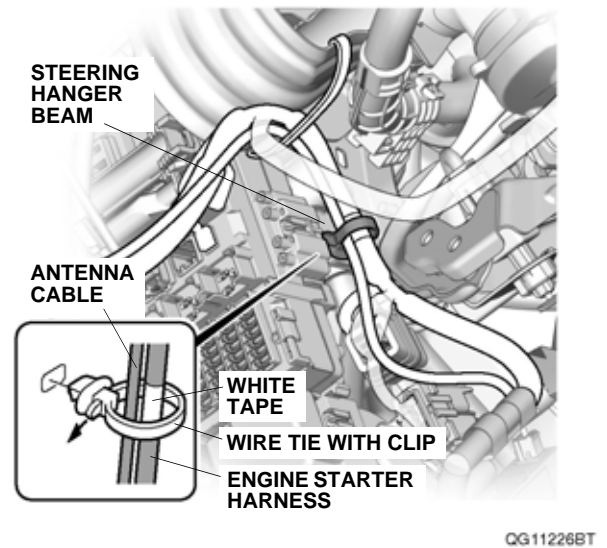

70. Bundle up the excess antenna cable as shown, and wrap one urethane tape around the antenna cable. Secure the antenna cable to the engine starter harness with one wire tie.
NOTE: Do not fold the antenna cable.

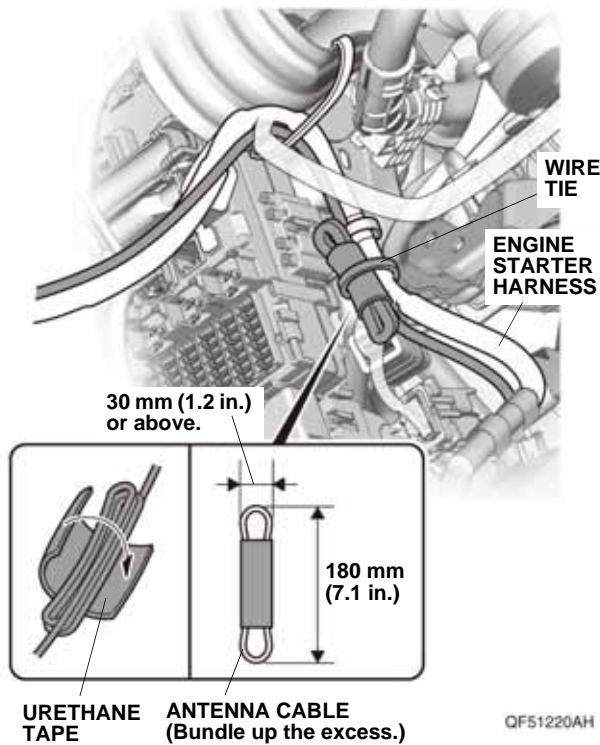

71. Using isopropyl alcohol on a shop towel, clean the hood where the caution label will attach.



72. Remove the adhesive backing from the caution label, and attach the caution label to the hood as shown.
73. Check that all wire harnesses are routed properly and all connectors are plugged in.
74. Check the overlap between the headliner and the driver's A-pillar trim. Refer to the service information. If necessary, to adjust the overlap.
75. Install all removed parts.
76. Connect the negative cable to the battery.
77. Press and hold the audio unit power button for 2 seconds to restore the audio and navi (if equipped) system functions.
78. Set the clock.
79. If necessary, restore the systems back to normal operation as described in the service information.
80. Perform the "REMOTE ENGINE STARTER REGISTRATION" and the "Check the Operation of the Remote Engine Start System II."

REMOTE ENGINE STARTER REGISTRATION

NOTE: Register after making sure the *i*-HDS has been upgraded to the latest version as described in the Service News.

1. Acquire the PCM-Code from the Interactive Network.
2. Connect the *i*-HDS to the vehicle, then set the power mode to ON. Start the Diagnostic System.

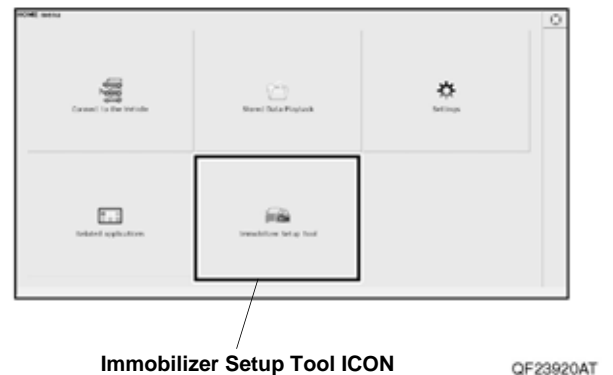

3. Click the Immobilizer Setup Tool icon.

4. Start the Immobilizer Setup Tool, and click the Start icon.



Start ICON

QF41901AT

5. Click the OK icon.



OK ICON

QF41902AT

6. Enter the PCM-Code, then click the OK icon.

Enter the "PCM-Code."



OK ICON

QF41903AT

7. Select "R/C ENG STARTER."

Select "R/C ENG STARTER."

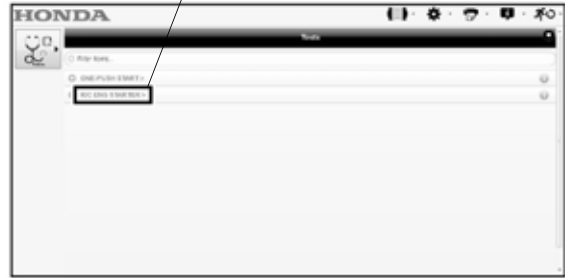

QF41904AT

8. Confirm that "REGISTER REMOTE CONTROL ENGINE STARTER UNIT" is displayed, then click the "➤" icon.

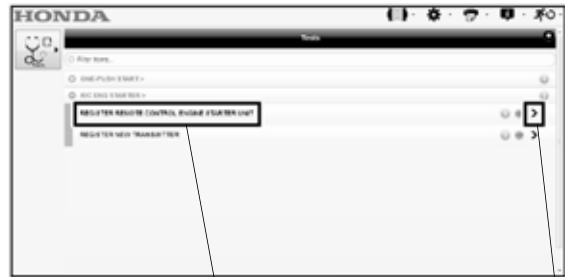

Confirm that "REGISTER REMOTE CONTROL ENGINE STARTER UNIT" is displayed.

"➤" ICON

QF23906AT

9. The following message will display: "The registration of the Remote Control Engine Starter Unit has been completed." Set the power mode to OFF.

"The registration of the Remote Control Engine Starter Unit has been completed."

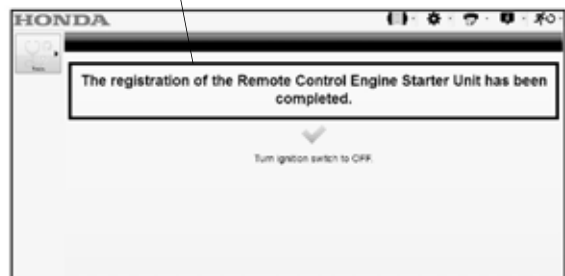

QF23907AT

- The following message will display: **“Check that engine can be started by the Transmitter.”** Click the OK icon.

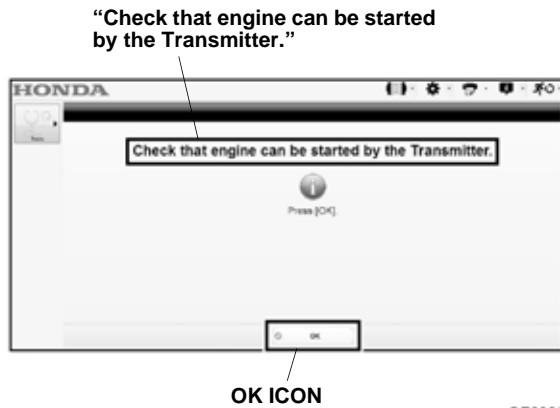

- The following message will display: **“Turn ignition switch to ON.”** Set the power mode to ON.

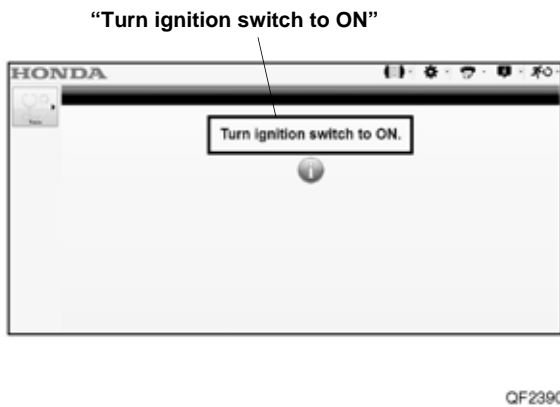

- Confirm that “☑” is displayed.



- Do the Check the Operation of the Remote Engine Start System II on page 26. Clear the DTCs, then disconnect the *i*-HDS.

Check the Operation of the Remote Engine Start System II

Operating Conditions

- The hood is closed.
- The shift lever is in Park.
- Set the power mode to OFF and the key is outside the vehicle.
- All doors and tailgate are closed and locked.

Inspection

1. Press the ENGINE button on the transmitter and release. Within 2 seconds, press the Lock/Start button on the transmitter.
The engine should start if all operating conditions are met.

Does the engine start?

Yes - Operation is normal.
No: <ul style="list-style-type: none">• Make sure all Operating Conditions are met.• Check the engine starter harness connections.• Connect the i-HDS and check for an indicated failure. (Refer to the service information for details.)

2. Press the ENGINE button on the transmitter and release. Within 2 seconds, press the Unlock/Stop button. The engine should stop.

Does the engine stop?

Yes - Operation is normal.
No - Check the engine starter harness connections.

3. After the engine has stopped, start the engine again and check that the engine stops after each of the following conditions:

NOTE: After each test the key must be cycled, or the driver's door must be opened and closed.

- Move the shift lever out of the Park.
- Unlock or open the doors or the tailgate.
- Open the hood.
- Set the power mode to ON.
- Press on the brake pedal.

Does the engine stop after each of these tests?

Yes - Operation is normal.
No - Check the engine starter harness connections.

4. Check that the power windows and the moonroof do not work and the shift lever does not move to any position when the engine is started with the transmitter.
5. Check that the engine does not start under "Operating Conditions" with the key left inside the vehicle.
6. Start the engine again, press the ENGINE button on the transmitter two times, and check the vehicle condition on the display.
7. Check the operation of the transmitter when the vehicle is 120 m (400 ft.) away and in direct sight.
8. Press the Unlock/Stop button on the transmitter and verify that the doors unlock. Press the Lock/Start button and verify that the doors lock.

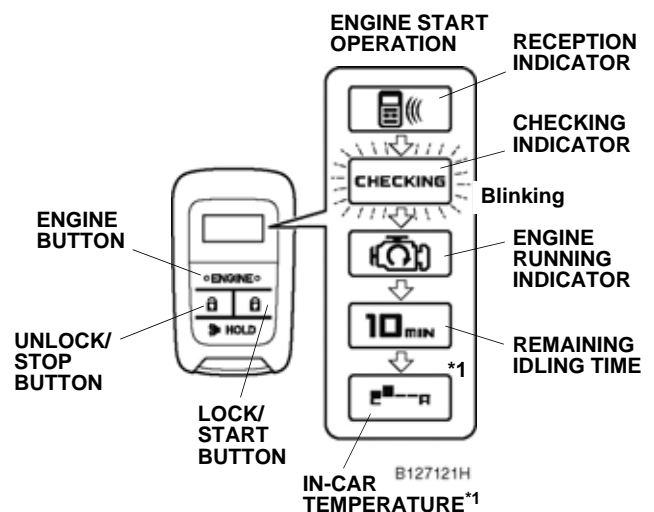

*1 Only on vehicles equipped with the automatic climate control. This indicator is displayed for some vehicles among them.